

VICINITY MAP NOT TO SCALE

NORTH CAROLINA, McDOWELL COUNTY

DocuSigned by:
Kenneth D Suttles
F338C1953E20408...

P.L.S. No. L-2678

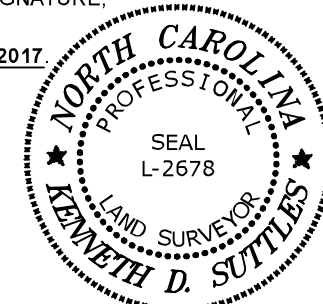

G.S. 47-30(f)(11)c.(1):
THIS SURVEY IS OF AN EXISTING PARCEL (OR PARCELS) OF
LAND AND DOES NOT CREATE A NEW STREET OR CHANGE
AN EXISTING STREET.

NORTH CAROLINA, BURKE COUNTY

I, Phillip Lookadoo, REVIEW OFFICER OF
THE CITY OF MORGANTON, CERTIFY THAT THE MAP OR PLAT TO WHICH THIS
CERTIFICATION IS AFFIXED MEETS ALL STATUTORY REQUIREMENTS
FOR RECORDING.

1/8/2018	<i>P. K. K. K.</i>
DATE	REVIEW OFFICER

NORTH CAROLINA, BURKE COUNTY









THE FOREGOING CERTIFICATE OF _____,
REVIEW OFFICER FOR THE CITY OF MORGANTON IS CERTIFIED TO BE CORRECT
AND FILED FOR REGISTRATION ON THIS _____ DAY OF _____, 2017
AT _____ AM / PM IN BOOK _____, PAGE _____.

REGISTER OF DEEDS



SCALE: 1" = 30'	DRAWN BY: R. Childres, PLS
DATE: December 21, 2017	APPROVED BY: KENNETH D. SUTTLES
FIELD CREW: KDS, WDL, CEH, LAS	

LEGEND

- | | | | |
|---|---|---|---------------|
|  | COMPUTED POINT |  | BOUNDARY LINE |
|  | 5/8" REBAR SET |  | TIE LINE |
|  | EXISTING IRON (type noted) |  | ADJOINER LINE |
|  | CONCRETE MONUMENT, GEODETIC MONUMENT | | |
|  | P.K. NAIL, RAILROAD SPIKE, COTTON GIN SPIKE | | |
|  | POWER POLE | | |

COMPUTER Map Room 2 FIELD BOOK 2017-12
FILE NAME 14193.deg MAP FILE No. 14193

PHYSICAL ADDRESS:
1417 Bethel Road
Morganton, NC 28655

REVISIONS:

TAX MAP INFORMATION			
SHEET	BLOCK	LOT	TWP No.
	NCPIN# - 2713704098		

Survey For:
Ruth C. Cline
Morganton Township, Burke County, North Carolina

Firm Number
C-0648



Suttles Surveying, P.A.

40 SOUTH MAIN STREET
Suite 200
MARION, NORTH CAROLINA
(878) 652-0382 28752

419 SOUTH KING STREET
MORGANTON, NORTH CAROLINA
(878) 433-0423 28613